

# Kawasaki

## Assembly Instructions

Model:	TERYX KRX / TERYX KRX4
Description:	Tow Hook
Part Number:	99994-1315
Assembly Time:	5 Minutes

**Before you begin, read through these instructions and check that all parts are present. Please note that Kawasaki cannot assume any responsibility for damage resulting from incorrect installation. Kawasaki recommends that all genuine accessories should be fitted by an authorized Kawasaki dealer.**

The following symbols indicate the information for proper installation and operation in this instruction.

**NOTE** : *NOTE indicates information that may help or guide you in the operation or service of the vehicle.*

- Indicates a procedural step or work to be done.
- Indicates a procedural sub-step or how to do the work of the procedural step it follows. It also precedes the text of a NOTE

Parts List			
No.	Component Name	Qty	Remark
1	Hex Flanged Bolt M10 x 75	2	
2	Hex Flanged Nylon Nut M10	2	
3	Tow Hook	1	

Parts Photo

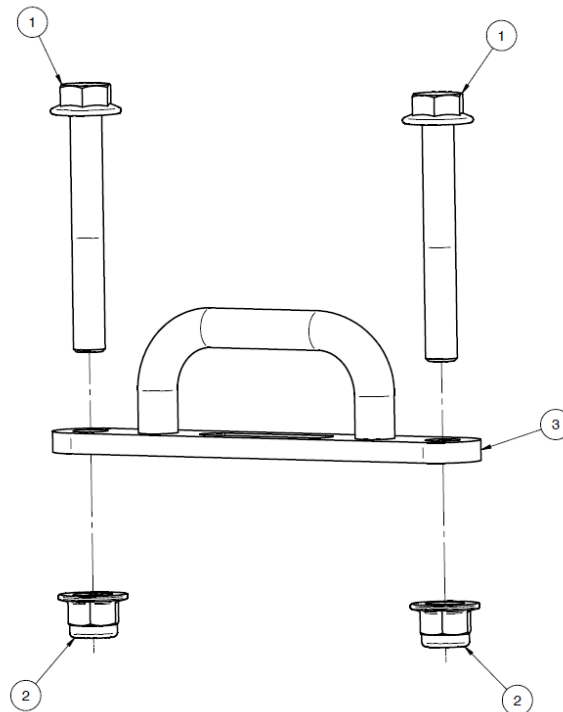

## Installation Instructions

- Park the vehicle on level ground, set the parking brake, turn off the ignition switch.

### Front installation

#### NOTE

- If you want to install the front bumper, you will need to install it first.

- Align the Tow Hook (3) over the mounting holes. Then screw it in place using two M10x75 Hex Flanged Bolts (1) and two M10 Hex Flanged Nylon Nuts (2).

**Torque – M10 Bolts: 38 N·m (3.87 kgf·m, 28 ft·lb)**

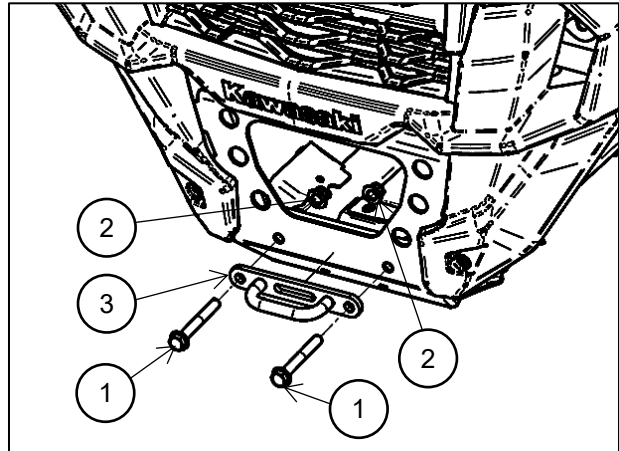

### Rear Installation

#### NOTE

- If you want to install the Rear bumper, you will need to install it first.

- Align the Tow Hook (3) over the mounting holes. Then screw it in place using two M10x75 Hex Flanged Bolts (1) and two M10 Hex Flanged Nylon Nuts (2).

**Torque – M10 Bolts: 38 N·m (3.87 kgf·m, 28 ft·lb)**

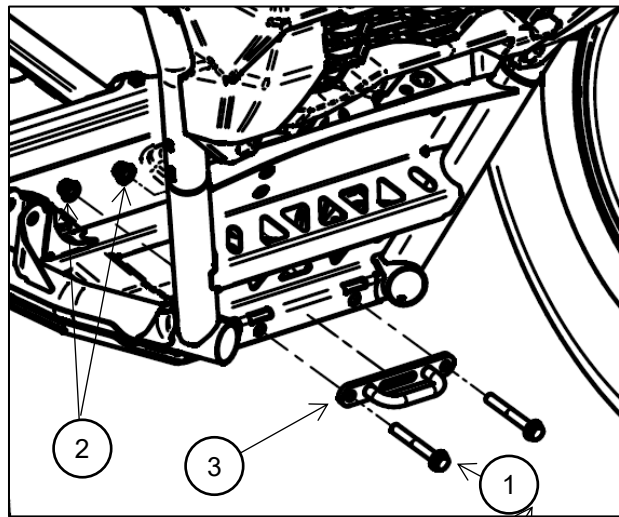

Enjoy your Kawasaki Genuine Accessory!